

## Media Circle Parcel B 3D Model

This model was created in 2016.

The model need be opened with the software Autodesk 3ds Max 2020 or later.

\*3D Model may differ from on-site measurement and site's surrounding may change after launch.

Massing models are developments completed post 2016 and do not have landscaping details.

Preview images





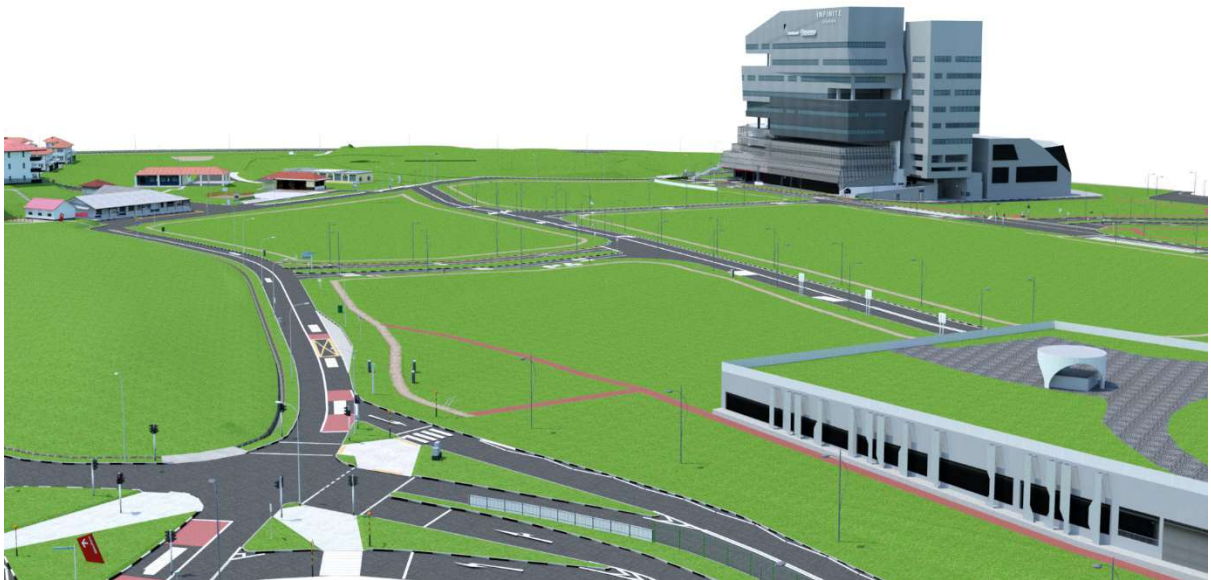

## **TERMS AND CONDITIONS FOR LICENCE AND USE OF DIGITAL 3D MODEL BELONGING TO URBAN REDEVELOPMENT AUTHORITY**

By purchasing and downloading the digital 3D model (“the Model”), the Urban Redevelopment Authority (“the Licensor”) is hereby granting to you a Licence to use the Model and you (the Licensee) are hereby accepting the grant of this Licence on and subject to the following terms and conditions:

- 1 This Licence is a personal, revocable, non-exclusive and non-transferrable licence for the Licensee to use the Model for its own purposes and benefit only. The Licensee shall not assign, sub-license or transfer its rights under this Licence to any third party.
- 2 The Licensee may use and authorize its employees, agents, consultants and contractors to use the Model but only for the Licensee’s own purposes and benefit. The Licensee shall ensure that the use of the Model, including use by its employees, agents, consultants and contractors, will not be in any way detrimental to the Licensor.
- 3 Other than as mentioned in paragraph 2, the Licensee shall not allow any third party to use or disclose or make available to any third party the Model or copies thereof.
- 4 The Licensee shall ensure that the Model is safely kept and no unauthorized use of the Model or copies thereof is made by any third party.
- 5 The Licensor is not responsible for and does not warrant the accuracy of any data comprised in the Model.
- 6 The Licensee accepts that the data comprised in the Model is not surveyed data and acknowledges that for the purpose of any application or formal submission of proposal to any authorities, the Licensee shall be responsible to ensure that updated surveyed datasets acquired from the relevant authorities are used.
- 7 The Licensee has the full power and right to accept the grant of this Licence on the terms and conditions set out herein and shall comply with all applicable laws, statutes, rules and regulations in the use of the Model under this Licence.
- 8 The Licensee shall indemnify and hold harmless the Licensor and its agents, contractors, officers and employees (the “Indemnified Parties”) from any and all losses, costs, expenses, damages and liabilities resulting from any –
  - (a) breach or non-compliance by the Licensee of any of the terms and conditions of this Licence; or
  - (b) claim against any of the Indemnified Parties associated with the grant of this Licence by the Licensor to the Licensee.

- 9 The Licensee acknowledges and agrees that –
  - (a) the Licensor is the sole and exclusive owner of the intellectual property rights, including copyright and other proprietary rights, in and to the Model; and
  - (b) the Licensee shall not deal with the Model in any manner except as expressly provided and permitted under this Licence.
- 10 The Licensor shall have the right to revoke this Licence in the event of any breach or non-compliance by the Licensee of any of the terms and conditions of this Licence.
- 11 For the purposes and in relation to this Licence, the Licensee shall be solely responsible and liable for the acts and omissions of its employees, agents, consultants and contractors.
- 12 A person who is not a party to this Licence shall have no right under the Contracts (Rights of Third Parties) Act (Cap. 53B) to enforce any of the terms and conditions of this Licence.
- 13 This Licence shall be governed by and construed in accordance with the laws of Singapore and the Licensor and Licensee shall submit to the exclusive jurisdiction of the courts of Singapore.